

# CORNER RECORD

Agency Index **BK 120 PG 60**  
Document Number **CR12250**

City of San Lorenzo County of Alameda, California  
Brief Legal Description MON along Via Del Rey

## CORNER TYPE

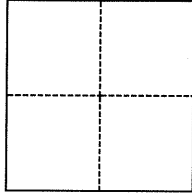

- ☐ Government Corner ☒ Control  
☐ Meander ☐ Property  
☐ Rancho ☐ Other

Date of Survey 9-5-18

## COORDINATES (Optional)

N. 2070841.88 E. 6088104.15  
Elevation \_\_\_\_\_

Units ☐ Metric ☒ U.S. Survey Foot

Horizontal Datum \_\_\_\_\_

Zone 3 Epoch Date \_\_\_\_\_

Vertical Datum \_\_\_\_\_

☐ Complies with Public Resources Code §§8801-8819

☐ Complies with Public Resources Code §§8890-8902

PLS Act Ref.: ☐ 8765(d) ☒ 8771 ☐ 8773 ☐ Other:  
Corner/Monument: ☒ Left as found ☐ Established ☐ Rebuilt ☐ Pre-Construction  
☐ Found and tagged ☐ Reestablished ☐ Referenced ☒ Post-Construction

Narrative of corner identified and monument as found, set, reset, replaced, or removed:

☐ See sheet #2 for description(s):

City Monument - CR10208

## SURVEYOR'S STATEMENT

This Corner Record was prepared by me or under my direction in conformance with

the Professional Land Surveyors' Act on

Signed [Signature] 9-14-2018  
P.L.S. or P.C.E. No. 5254

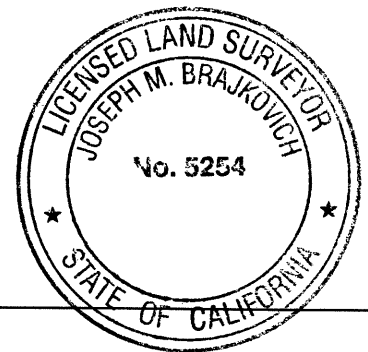

## COUNTY SURVEYOR'S STATEMENT

This Corner Record was received 2 OCTOBER 2018

and examined and filed 6 MAY 2019

Signed Michael Rubner P.L.S. or P.C.E. No. 6843

Title COUNTY SURVEYOR

County Surveyor's Comment



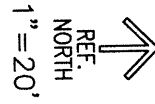

LEGEND

- MONUMENT
- CUT X

