



PANDA RESTAURANT GROUP INC.
1683 Walnut Grove Ave.
Rosemead, California
91770
Telephone: 626.799.9898
Facsimile: 626.372.8288

All ideas, designs, arrangement and plans indicated or represented by this drawing are the property of Panda Express Inc. and were created for use on this specific project. None of these ideas, designs, arrangements or plans may be used by or disclosed to any person, firm, or corporation without the written permission of Panda Express Inc.

REVISIONS:	

ISSUE DATE:	
1	08.20.2021 ISSUE FOR PERMIT

DRAWN BY: JEL/DSM

PANDA PROJECT #: - S8-22-D8086
C&P PROJECT #: - 2200772



Culaci & Peterson
Architects Engineers Planners

2600 Maitland Center Pkwy, Maitland, FL 32751
P (407) 661-9100
F (407) 661-9101
www.culaci.com
Panda Express is a registered trademark of Panda Express Inc.

08.20.2021

Digitally signed by Jaison Moras
Reason: The document has been digitally signed and sealed by Jaison Moras on the date adjacent to the seal. Printed copies of this document are not considered signed and sealed and the signature must be verified on any electronic copy.
Date: 2021.08.16 16:56:41 -0400

JAISON MORAS,
FL #76917

PANDA EXPRESS

TRUE WARM AND WELCOME 2300
34898 EMERALD COAST PARKWAY
DESTIN, FL 32451

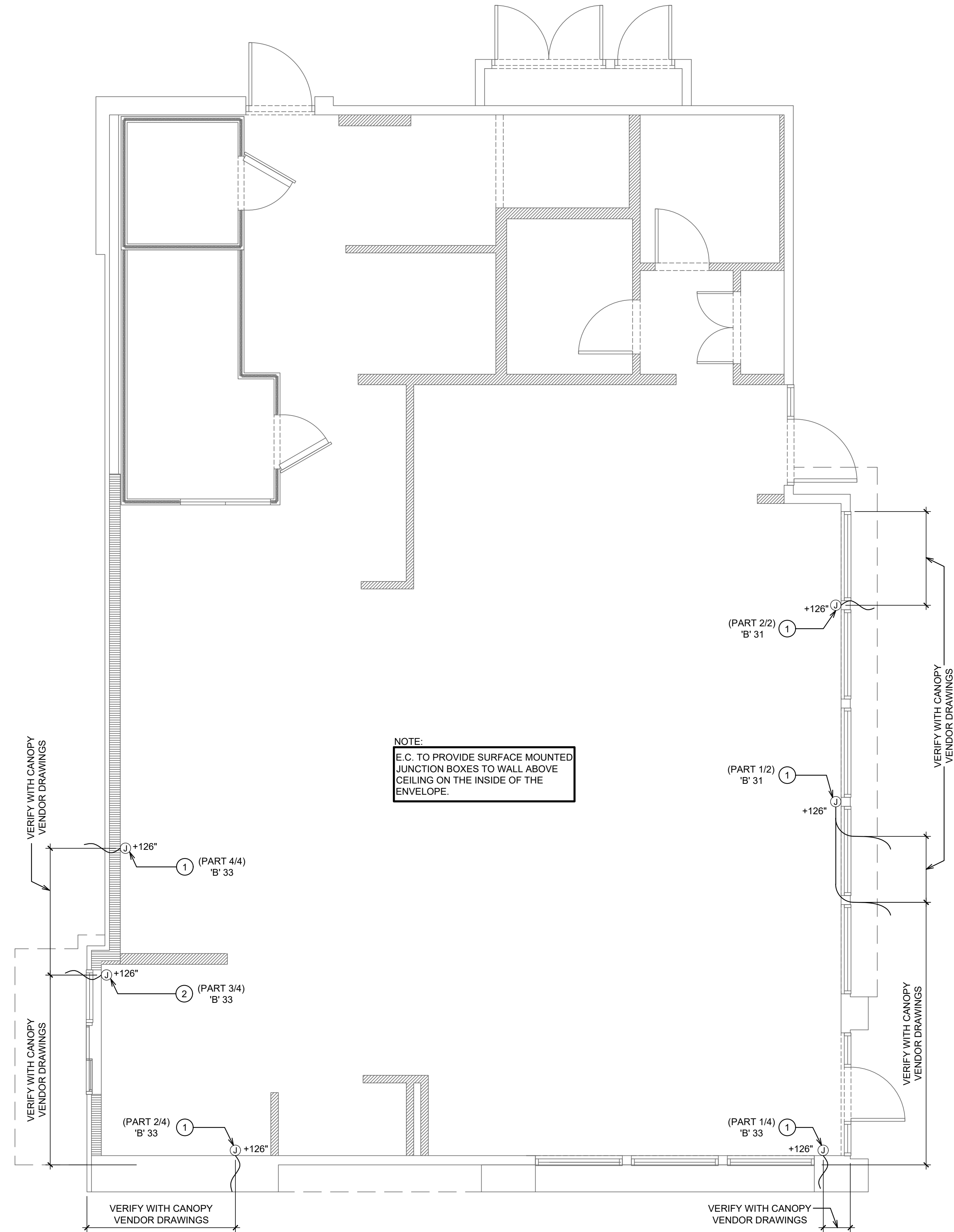

1. E.C. TO PROVIDE J-BOX WITH 3' WHIP FOR CONNECTION TO PANDA EXPRESS PROVIDED LIGHTED CANOPY. E.C. TO MAKE FINAL CONNECTION.	
2. E.C. TO PROVIDE J-BOX WITH 3' WHIP FOR CONNECTION TO PANDA EXPRESS PROVIDED LIGHTED DRIVE THRU CANOPY. E.C. TO MAKE FINAL CONNECTION.	
3. ALL JUNCTION BOXES ON THIS SHEET TO BE RECESS MOUNTED.	
#	2
CANOPY LIGHTING KEYED NOTES	
NOT TO SCALE E-101.1	

CANOPY LIGHTING PLAN	
Scale: 1/4"=1'-0"	
E-101.1	