

# CORNER RECORD

Agency Index

BK 131 PG 101

Document Number

CR12643City of OAKLANDCounty of ALAMEDA

, California

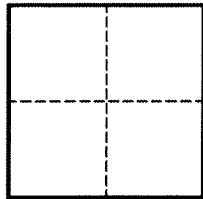
Brief Legal Description MONUMENT AT INTERSECTION OF CLARKE STREET AND REDONDO WAY**CORNER TYPE****COORDINATES (Optional)**

- ☐ Government Corner ☒ Control  
☐ Meander ☐ Property  
☐ Rancho ☐ Other

Date of Survey DECEMBER 20, 2018

N. \_\_\_\_\_ E. \_\_\_\_\_

Elevation N/AUnits ☐ Metric ☒ U.S. Survey FootHorizontal Datum LOCAL SITE DATUM

Zone \_\_\_\_\_ Epoch Date \_\_\_\_\_

Vertical Datum N/A☐ Complies with Public Resources Code §§8801-8819☐ Complies with Public Resources Code §§8890-8902

PLS Act Ref.:

☐ 8765(d)☒ 8771☐ 8773☐ Other:Corner/  
Monument:☒ Left as found☐ Established☐ Rebuilt☒ Pre-Construction☐ Found and tagged☐ Reestablished☒ Referenced☐ Post-Construction

Narrative of corner identified and monument as found, set, reset, replaced, or removed:

☐ See sheet #2 for description(s):

CITY OF OAKLAND MONUMENT, A FOUND 3/8" ROD WITH PUNCH SET IN CONCRETE IN MONUMENT BOX AT THE INTERSECTION OF CLARKE STREET AND REDONDO WAY, WAS REFERENCED PRIOR TO THE START OF SANITARY SEWER WORK BY RAD URBAN.

**SURVEYOR'S STATEMENT**

This Corner Record was prepared by me or under my direction in conformance with

the Professional Land Surveyors' Act on February 13, 2020

Signed

P.L.S. or R.C.E. No.

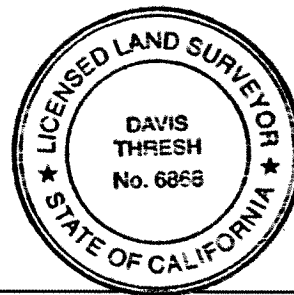
6868**COUNTY SURVEYOR'S STATEMENT**

This Corner Record was received

FEB 18 2020

and examined and filed

FEB 18 2020

Signed

P.L.S. or R.C.E. No.

7010Title **ALAMEDA COUNTY SURVEYOR**

County Surveyor's Comment

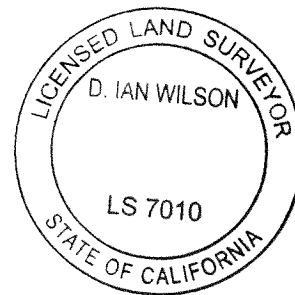

**LEGEND**

- ⊙ FOUND CITY MONUMENT
- SET MAG NAIL AND WASHER AS NOTED
- SET MAG NAIL AND SHINER AS NOTED

